

Current part is item (4) on diagram. Available at www.oshkoshequipment.com

(1) (a) FIG. NO.	(2) (b) ITEM NO.	(3) SMR CODE	(4) NATIONAL STOCK NUMBER	(5) (6) PART NUMBER	(6) DESCRIPTION FSCM	(7) U/M	(8) INC IN UNIT
4041-MUFFLER AND PIPES (CONT'D)							
46	39	XAOZZ		10937403	19207 BRACKET AC	EA	2
46	NI	PAOZZ	5330-00-899-4481	10889768	19207 GASKET: TURBO SUPERCHARGER EXHAUST ELBOW INNER AB	EA	1
46	NI	PAOZZ	2990-00-860-2335	7748883	19207 ELBOW,EXHAUST: TURBO SUPERCHARGER AB	EA	1
46	NI	PAOZZ	5330-00-899-4482	10889769	19207 GASKET AB	EA	1
NOTE: THE FOLLOWING 29 ITEMS ARE USED ON M44A2 SERIES TRUCKS, WITH THE EXCEPTION OF MODELS M50A2 AND M50A3.							
47	1	PAOZZ	5306-00-225-9094	MS90726-39	96906 BOLT,MACHINE: COUPLING TO EXHAUST PIPES	EA	3
47	2	PAOZZ	5340-00-194-1665	11609348-10	19207 COUPLING: EXHAUST PIPE	EA	3
47	3	PAOZZ	5330-00-127-5417	11609349-2	19207 GASKET: EXHAUST PIPE AND EXHAUST FLEX TUBE	EA	3
47	4	PAOZZ	2990-00-104-2836	11677091	19207 PIPE,EXHAUST	EA	1
47	5	PAOZZ	5310-00-176-6690	11609727-2	19207 NUT,SELF-LOCKING	EA	6
47	6	PAOZZ	5340-00-097-6399	11677122	19207 BRACKET: EXHAUST SHIELD TO EXHAUST PIPE	EA	2
47	7	PAOZZ	5310-00-139-4627	11609727-1	19207 NUT,SELF-LOCKING	EA	6
47	8	PAOZZ	2990-00-104-2895	11677118	19207 SUPPORT,EXHAUST	EA	1
47	9	PAOZZ	2990-00-104-2896	11677120	19207 BRACE,EXHAUST SUPPORT	EA	1
47	10	PAOZZ	5310-00-637-9541	MS35338-46	96906 WASHER,LOCK	EA	1
47	11	PAOZZ	5305-00-269-2808	MS90726-65	96906 SCREW,CAP,HEXAGON HEAD	EA	1
47	12	PAOZZ	5340-00-097-6512	11676955	19207 CLAMP ASSEMBLY: EXHAUST SHIELD	EA	1
47	13	PAOZZ	5340-00-054-3173	11677063	19207 PLATE,COVER	EA	2
47	14	PAOZZ	5310-00-809-3078	MS27183-11	96906 WASHER,FLAT	EA	4
47	15	PAOZZ	5310-00-081-4219	MS27183-12	96906 WASHER,FLAT	EA	4
47	16	PAOZZ	5340-00-097-6456	11677121	19207 BRACKET: MANIFOLD PIPE	EA	1
47	17	PAOZZ	5306-00-225-9089	MS90726-34	96906 BOLT,MACHINE	EA	2
47	18	PAOZZ	5340-00-097-6915	11676872-3	19207 CLAMP: MANIFOLD PIPE BRACKET	EA	1
47	19	PAOZZ	2990-00-104-2861	11663019	19207 TUBE,EXHAUST FLEX	EA	1
47	20	PAOZZ	2990-00-104-2794	11677093	19207 ELBOW ASSEMBLY: EXHAUST MANIFOLD	EA	1
47	21	PAOZZ	5330-00-106-8555	11677119	19207 GASKET: EXHAUST MANIFOLD ELBOW	EA	1
47	22	PAOZZ	5340-00-092-6372	MS27116-15B	96906 COUPLING: EXHAUST MANIFOLD ELBOW	EA	1
47	23	PAOZZ	5310-00-959-1488	MS51922-21	96906 NUT,SELF-LOCKING	EA	1

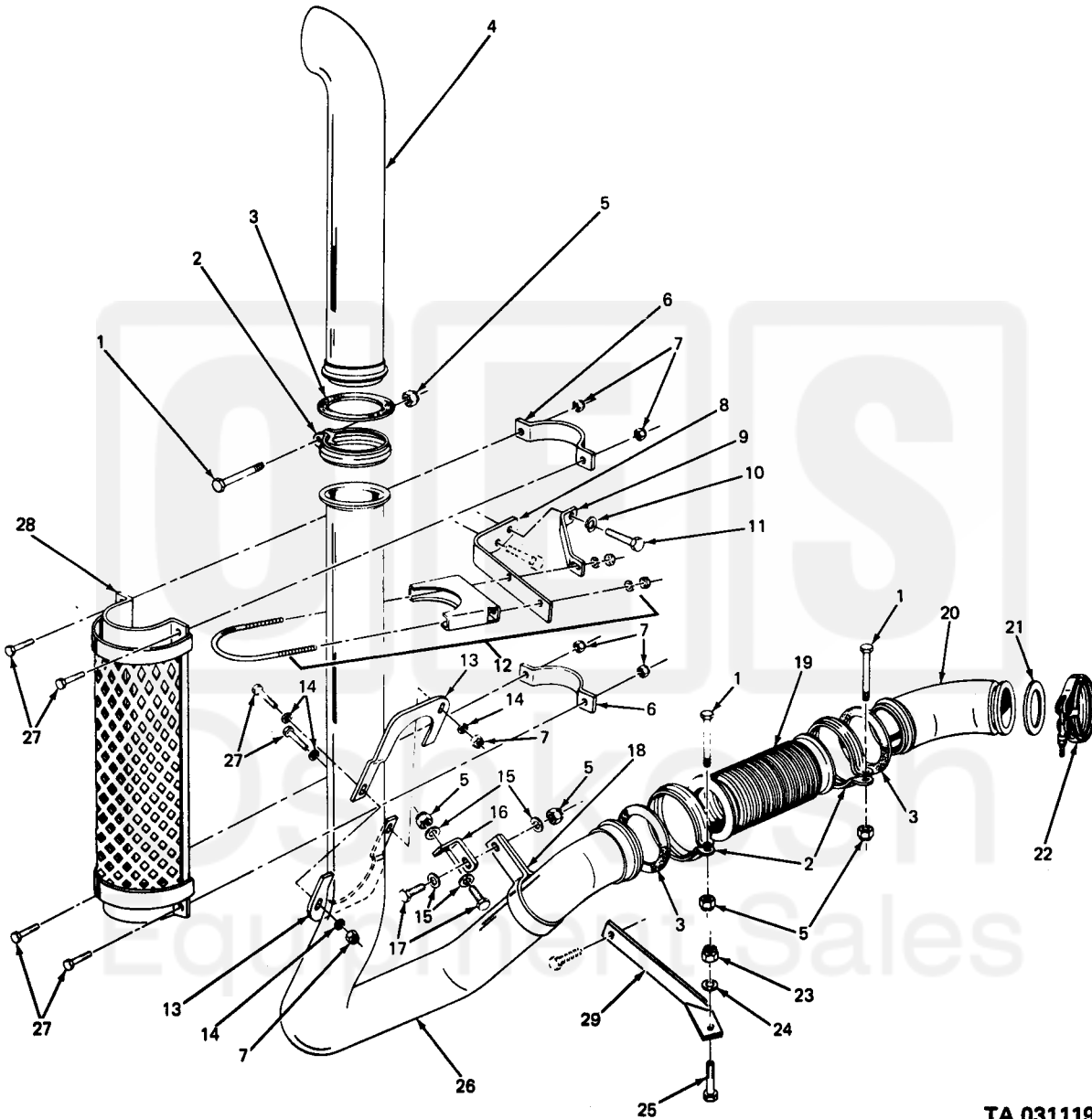

Current part is item (4) on diagram. Available at www.oshkoshequipment.com



TA 031119

Figure 47. Engine exhaust pipes and stack pipe mounting (clean air).